

GROUND FLOOR

0

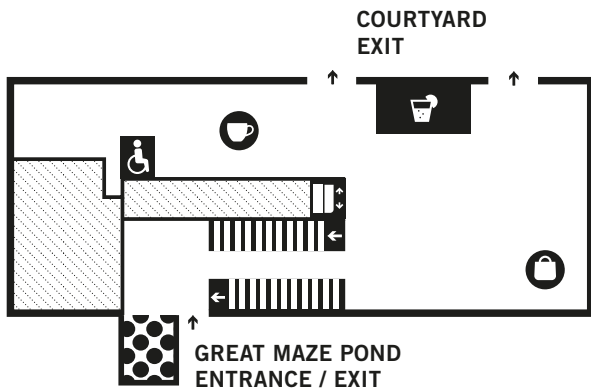

LOWER GROUND FLOOR

-1

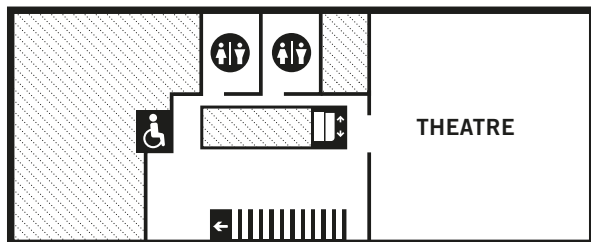

FIRST FLOOR

1

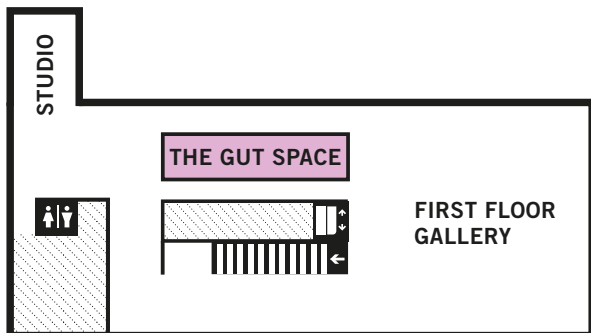

VISITOR INFORMATION

CAFÉ

Grab a drink from our bar from until 21:30 and enjoy food from the open kitchen until 21:00.

SHOP

From bespoke designs to quirky souvenirs, the Shop has a range of memorable gifts, books, toys and stationery inspired by art, science, health and medicine. Every purchase supports the work of Science Gallery London.

SPARE PARTS

RETHINKING HUMAN REPAIR

This event is part of a season exploring the art, science, technology and ethics of human repair and regeneration developed alongside researchers from King's College London.

Elements of this Late have been programmed by Science Gallery London Young Leaders Mandeep Singh, Laura Pieters, Bella Spencer and Angela Wereko-Anderson.

FIND OUT MORE AT

london.sciencegallery.com/spare-parts

FOLLOW US

   @SCIGALLERYLON #SPAREPARTS

IMAGE COPYRIGHT

FRONT PAGE: *Big Heart Data*, Salome Bazin

GROUND FLOOR: Image by Damien Frost
courtesy of Drag Syndrome

LOWER GROUND FLOOR: Sphinctograph by
Caitlin & Misha

FIRST FLOOR: QS Labs / Kate Farnady

SCIENCE GALLERY AT KING'S COLLEGE LONDON IS PART OF THE
GLOBAL SCIENCE NETWORK PIONEERED BY TRINITY COLLEGE DUBLIN.



FREE ENTRY

FRIDAY LATE: UNBREAKABLE

15 MAR 19

WHAT IS IT LIKE TO LIVE WITH A SPARE PART OR ALTERED ORGAN? ARE NEW TECHNOLOGIES GIVING US GREATER CONTROL OVER OUR BODIES AND IDENTITIES? AND HOW CAN OUR SOCIETY AND INFRASTRUCTURE BE BETTER SET UP TO MEET THE NEEDS OF ALL?

GROUND FLOOR

0



BODY-BUILDING

18:30–22:00

A collage making workshop with malady mag, where no bodies created are too far from the norm.

THE YONIS

THROUGHOUT THE EVENING

Movement girl band The Yonis will perform a track celebrating how our bodies can be individually expressive but still come together with others. Connect with your own body by joining their open band practice at 19:30.

DRAG SYNDROME

20:00–20:15

The world's first Drag collective of queens and kings with Down's syndrome explore the wonder of an extra chromosome in a boundary-pushing performance.

DIBS DJ SET

18:30–22:00

Enjoy an effortless blend of Afrobeats, Hip Hop, R&B & Future Beats from Dibs, a London based DJ, producer & music tech-maker.

LOWER GROUND

-1



ATRIUM

ACCESS-VILLE

18:30–22:00

Help us design a town that meets the needs of all, with illustrator Indigo Ayling. Head to the Access-Ville “bookshop” for inspiration from malady mag zine #1.

ANTIPHON

19:15–19:25

Opera singer Victoria Oruwari performs a sound work by artist Tabatha Andrews and composer Charlotte Harding, exploring the process of listening and altered senses.

THEATRE

THE ALT LIMB PROJECT

19:30–20:00

Sophie de Oliveira Barata uses the unique medium of prosthetics to create highly stylised works of art. Hear how she worked with Kelly Knox to create prosthetic arms that reflect her personality and redefine beauty.

SHAREABLE BIOME PERFORMANCE LECTURE

20:15–21:00

Is radical self-care for the microbiome possible? Artists Caitlin & Misha take a humorous look at fecal microbiota transplants and lead a microbiome meditation.

FIRST FLOOR

1



GALLERY

SPARE PARTS EXHIBITION

18:30–22:00

Exploring the art, science, technology and ethics of human repair and regeneration, the exhibition features artists and designers from across the globe who have collaborated with leading academics from King's College London.

SUPERTURD CARD GAME

18:30–22:00

Play a round of *SuperTurd* with King's PhD students Emily and Geraldine in The Gut and share your microbiome.

STUDIO

QUANTIFIED LIFE

19:10–19:45

Film screening and Q&A exploring whether our bodies exist as systems to be optimized and improved, with King's researcher Btihaj Ajana and Thomas Blomseth Christiansen, who through self-tracking has successfully rid himself of severe allergies.

ANTIPHON Q&A

19:50–20:20

Following her performance, Victoria Oruwari will share how she experiences the world through sound and discuss her collaboration for SPARE PARTS with artist Tabatha Andrews and composer Charlotte Harding